

SRP-6PA SERIES 6 INCH 72 CELLS

320-335w



KEY FEATURES



Bankable products



Safety for salt mist corrosion (IEC61701, tested in TÜV SÜD)



Safety for ammonia corrosion (IEC62716, tested in TÜV SÜD)



Top rank in Photon yield measurement



Safety for fire risk (Class C tested in TÜV SÜD and Rheinland)



Outstanding power output capability at low irradiance



Triple 100% Electroluminescence (EL) tests minimize breakage rate



World 1st company to pass "Thresher Test" and "On-site Power Measurement Validation" certificate



Anti-PID products, passing TÜV SÜD system voltage durability test

MANAGEMENT SYSTEM

ISO 9001: Quality management system

ISO 14001: Standard for environmental management system

OHSAS 18001: International standard for occupational health and safety assessment system

INSURANCE



PRODUCT CERTIFICATES



WARRANTY

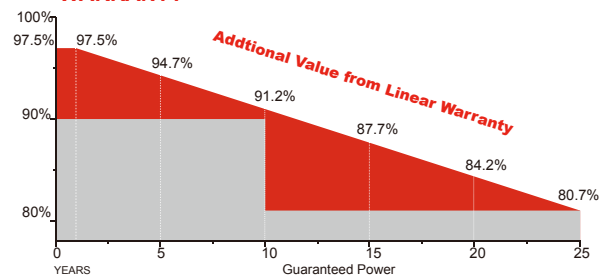

Guarantee on product material and workmanship



linear power output warranty

Specifications are subject to change without further notification SRP-DS-EN-2018V2.0 © Copyright 2018 Seraphim



SERAPHIM SOLAR SYSTEM CO., LTD.

www.seraphim-energy.com

info@seraphim-energy.com

Electrical Characteristics

Module Type	SRP-320-6PA		SRP-325-6PA		SRP-330-6PA		SRP-335-6PA	
	STC	NOCT	STC	NOCT	STC	NOCT	STC	NOCT
Maximum Power -P _{mp} (W)	320	236	325	240	330	244	335	248
Open Circuit Voltage -V _{oc} (V)	45.5	42	45.7	42.2	45.9	42.4	46.2	42.6
Short Circuit Current -I _{sc} (A)	8.96	7.24	9.03	7.30	9.12	7.37	9.20	7.43
Maximum Power Voltage -V _{mp} (V)	37	34.6	37.3	34.8	37.5	35.0	37.7	35.3
Maximum Power Current -I _{mp} (A)	8.65	6.83	8.72	6.89	8.80	6.98	8.89	7.02
Module Efficiency STC-η _m (%)	16.49		16.75		17.01		17.26	
Power Tolerance (W)	(0,+4.99)							
Maximum System Voltage (V)	1000 (TÜV)							
Maximum Series Fuse Rating (A)	15							
Pmax Temperature Coefficient	-0.41%/°C							
Voc Temperature Coefficient	-0.32 %/°C							
Isc Temperature Coefficient	+0.05 %/°C							
Operating Temperature	-40~+85 °C							
Nominal Operating Cell Temperature	45±2 °C							

STC: Irradiance 1000 W/m² module temperature 25°C AM=1.5
 NOCT: Irradiance 800 W/m² ambient temperature 20°C wind speed :1m/s Power measurement tolerance: +/-3%

Curve

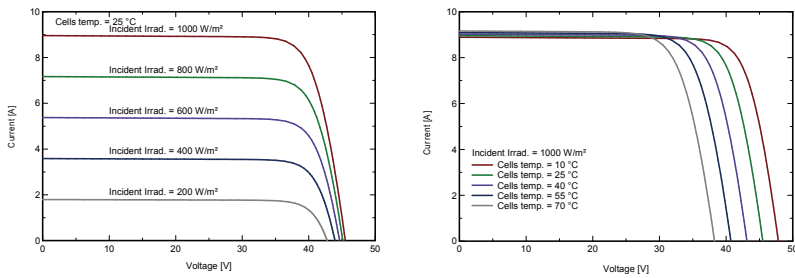

Technical drawing

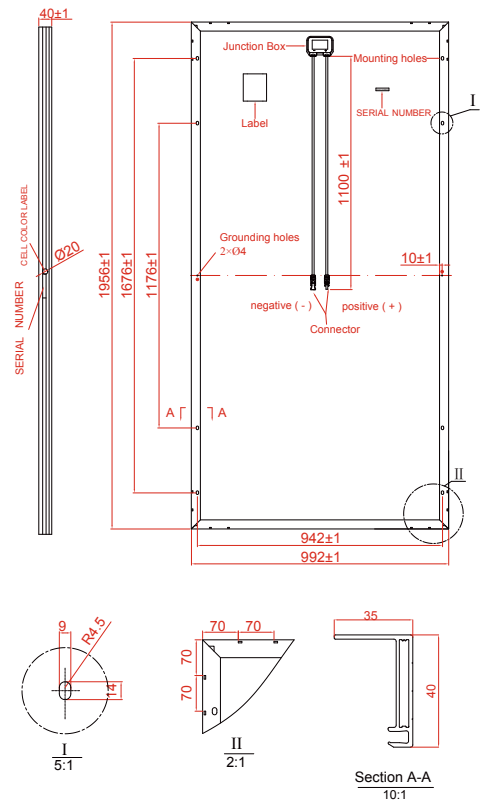

Mechanical Specifications

External Dimension	1956 x 992 x 40mm
Weight	21.5kg
Solar Cells	Poly crystalline 156.75 x 156.75 mm (72pcs)
Glass of Both Side	3.2 mm tempered glass, low iron
Frame	Anodized aluminium alloy
Junction Box	IP67
Output Cables	4.0 mm ² , cable length:1100 mm
Connector	MC4 Compatible
Mechanical Load	5400 Pa

Packing Configuration

External Dimension	1956 x 992 x 40mm	
Container	20'GP	40'GP
Pieces per Pallet	27	27
Pallets per Container	10	22
Pieces per Container	270	594

* All Dimensions in mm
 * The above drawing is a graphical representation of the product.
 For engineering quality drawings please contact SERAPHIM.